

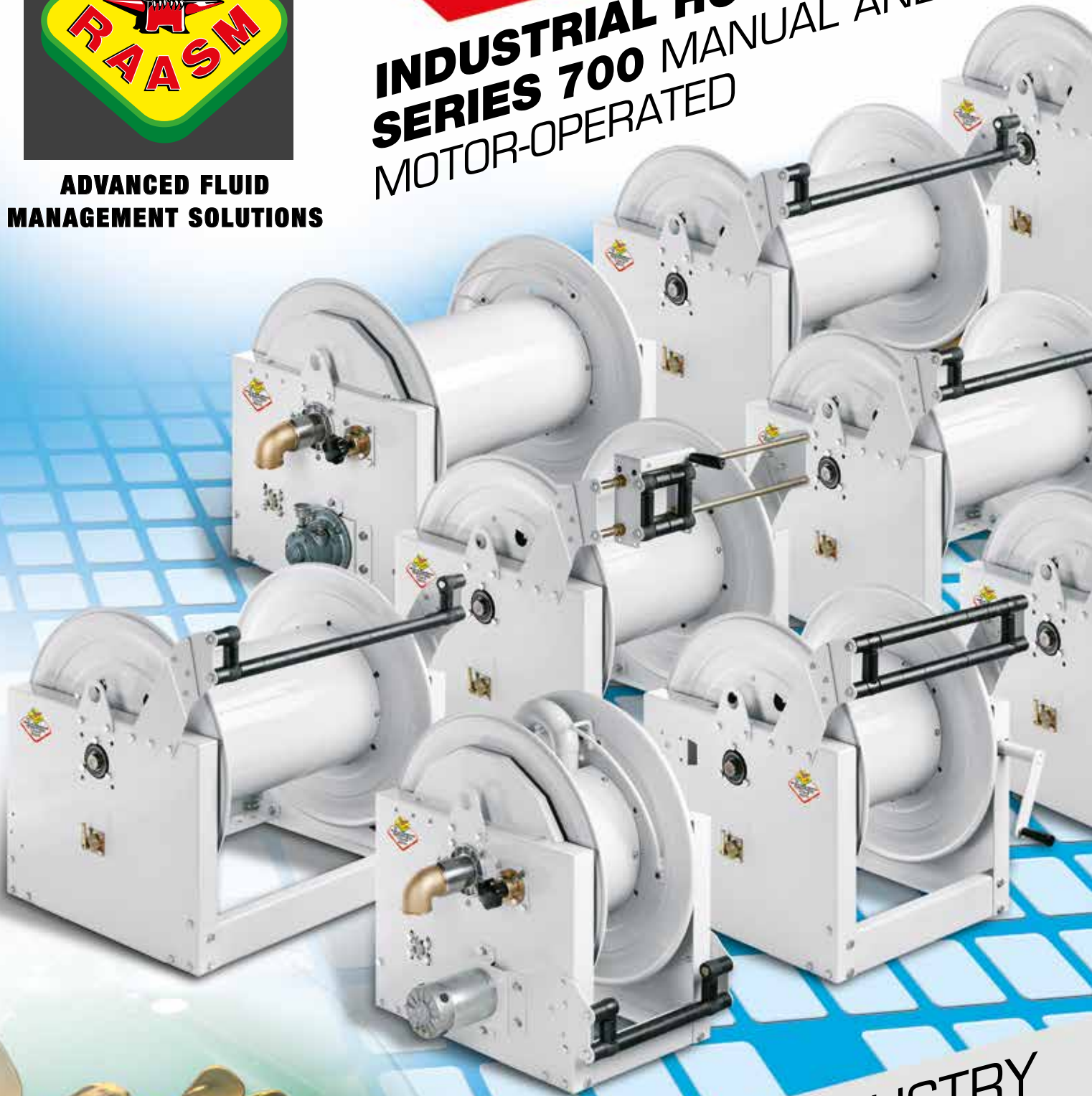

**ADVANCED FLUID
MANAGEMENT SOLUTIONS**

INDUSTRIAL HOSE REELS SERIES 700 MANUAL AND MOTOR-OPERATED



INDISPENSABLE FOR INDUSTRY

No. 220/700
1st April 2011





SERIES 700 MANUAL AND MOTOR-OPERATED PAINTED STEEL



INDEX

Technical characteristics page **4**



Series 700 manual page **6**



Series 700 electric 24V page **8**



Series 700 electric 230V page **9**



Series 700 hydraulic page **10**



Series 700 pneumatic page **11**

Accessories page **12**

Applications page **14**

▶ Standard open hose guide.
Enables fitting of two guides
in opposite directions (see figure
page 12 below)
Available on request.



▶ Standard closed hose guide.
Available on request.

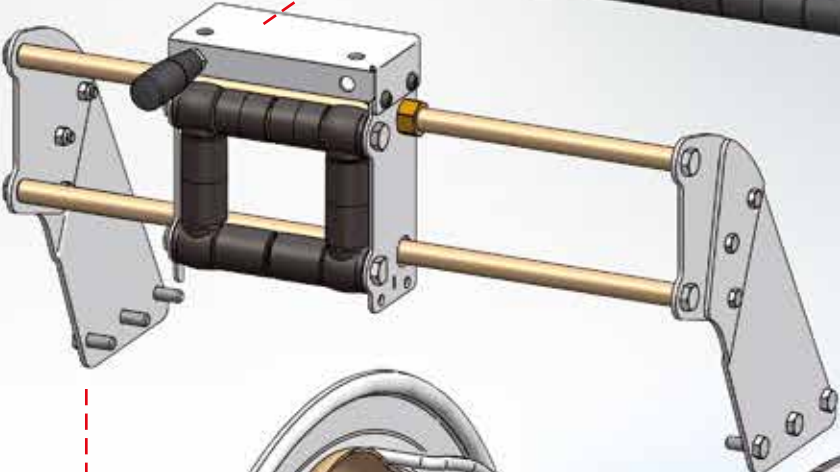

▶ Manual operation hose guide for
optimum winding of hose.
Available on request.

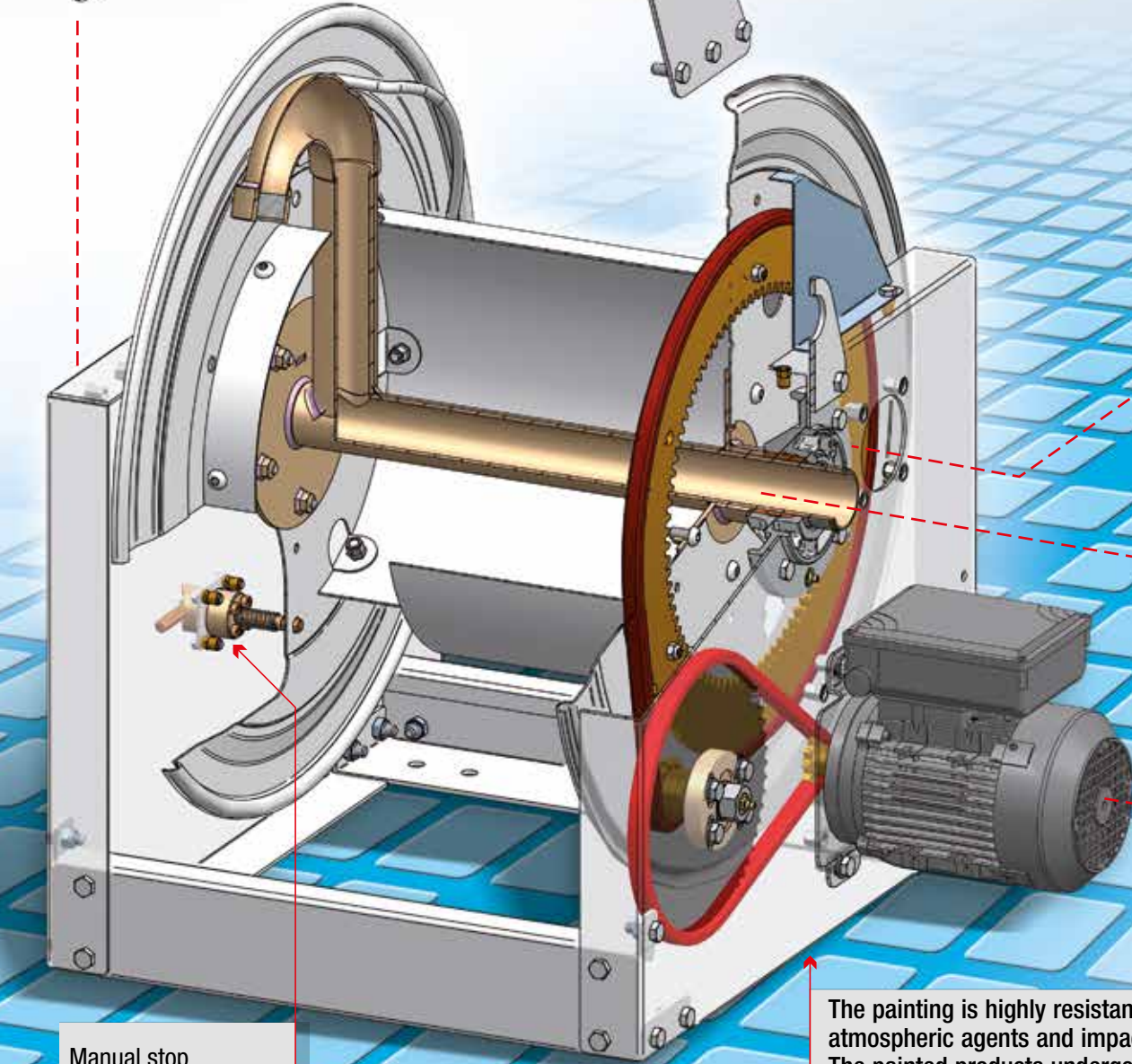

Version
with 230V
electric
motor.

Manual stop
preventing drum
movement.

The painting is highly resistant to
atmospheric agents and impacts.
The painted products undergo "saline mist
resistance" corrosion testing according to
UNI 9227 standards.

Technical characteristics



The exploded view below enables easy identification of the main parts making up the industrial hose reel, at the same time indicating the technical features.

As well as being **available with drum in 4 different widths**, the various hose reel models differ for:

- **type of motorisation** (manual, 24V electric, 230V electric, hydraulic, pneumatic)
 - 2" swivel joint max. **pressure** (20 bar or 70 bar)
 - **type and position of hose guide** (available on request)
 - **presence or not of the clutch** which regulates the hose unwinding speed.
- All the models have a manual drum stop.

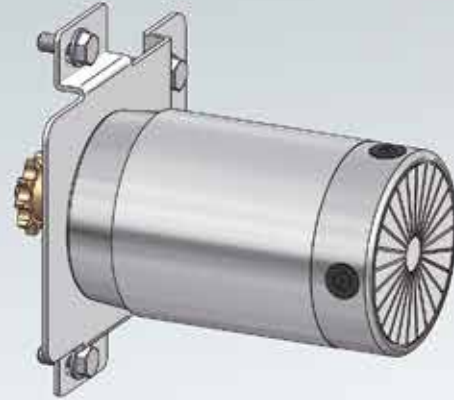

Version with 24V electric motor.

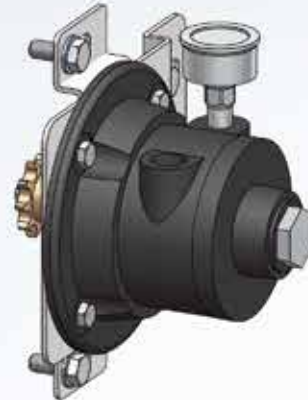

Version with pneumatic motor.

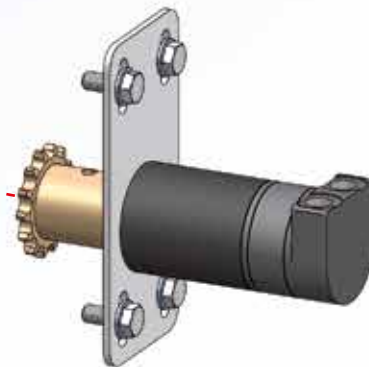

Version with hydraulic motor.

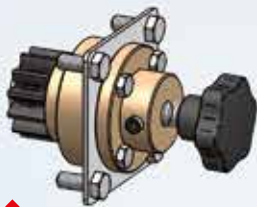

Adjustable clutch for correct hose unwinding. Available on request.

Swivel joint with total passage so as not to hinder the flow.

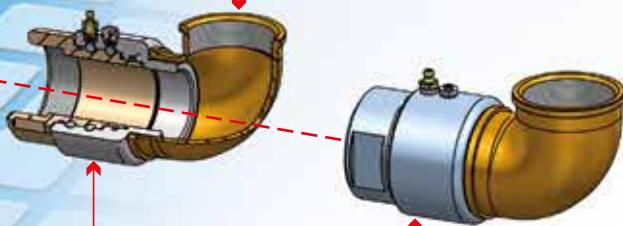

Aluminium 20 bar.

Steel 70 bar.

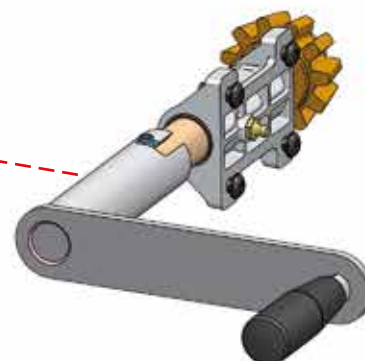

Version with handle connected to the rack.



SERIES 700 ELECTRIC 24V

PAINTED STEEL

The hose reels with 24V electric motor are a handy and easy answer to the problem of hose management. Hose unwinding occurs manually whereas rewinding is done with the electric motor connected to a battery or an electrical transformer.



	width 270 mm	width 410 mm	width 550 mm	width 690 mm	Connection	
					inlet	outlet
20 bar Air - Water Diesel fuel - swivel joint aluminium - seals in Viton®	7721301.100	7741301.100	7751301.100	7771301.100	2"	2"
70 bar Oil and allied products - swivel joint in carbon steel - seals in Viton®	7721301.400	7741301.400	7751301.400	7771301.400	2"	2"

DRUM CAPACITY					
Ø HOSE	Ø HOSE EXT.	L270	L410	L550	L690
3/8"	17 mm	160 m	290 m	420 m	550 m
1/2"	20 mm	110 m	180 m	280 m	350 m
3/4"	27 mm	65 m	120 m	180 m	244 m
1"	34 mm	30 m	60 m	100 m	134 m
1.1/4"	43 mm	20 m	35 m	60 m	84 m
1.1/2"	50 mm	15 m	30 m	50 m	75 m
2"	63 mm	10 m	20 m	30 m	43 m

24V electric hose reel power supply

The 24V motor can be connected to a battery or a current transformer connected to the 230V mains. An On/Off switch must be installed between the power supply and the hose reel.

24V DC MOTOR, 300W POWER

⚠ Attention: check the electrical connection for the correct direction of motor rotation.

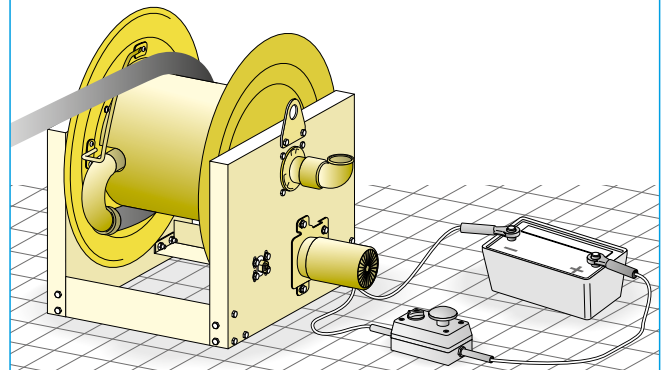

OVERALL DIMENSIONS

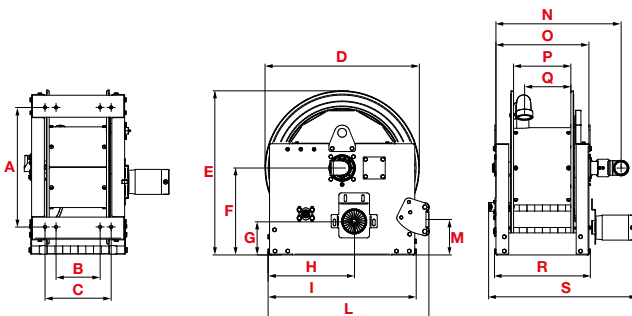

Art.	A	B	C	D	E	F	G	H	I	L	M	N	O	P	Q	R	S	1-m ³	Kg
L 270	542	200	300	700	760	410	150	390	670	730	160	570	422	260	210	435	630	0,53	100
L 410	542	340	440	700	760	410	150	390	670	730	160	712	562	398	350	575	770	0,63	110
L 550	542	480	580	700	760	410	150	390	670	730	160	850	705	538	490	717	915	0,73	117
L 690	542	620	720	700	760	410	150	390	670	730	160	990	842	680	630	855	1055	0,82	133



SERIES 700 ELECTRIC 230V

PAINTED STEEL

The hose reels with 230V electric motor are a handy and easy answer to the problem of hose management. Hose unwinding occurs manually whereas rewinding is done with the electric motor appropriately connected to the 230V power supply.

On request hose reels are available with following Atex Certification



	width 270 mm	width 410 mm	width 550 mm	width 690 mm	Connection	
					inlet	outlet
20 bar Air - Water Diesel fuel - swivel joint aluminium - seals in Viton®	7721601.100	7741601.100	7751601.100	7771601.100	2"	2"
70 bar Oil and allied products - swivel joint in carbon steel - seals in Viton®	7721601.400	7741601.400	7751601.400	7771601.400	2"	2"

DRUM CAPACITY					
Ø HOSE	Ø HOSE EXT.	L270	L410	L550	L690
3/8"	17 mm	160 m	290 m	420 m	550 m
1/2"	20 mm	110 m	180 m	280 m	350 m
3/4"	27 mm	65 m	120 m	180 m	244 m
1"	34 mm	30 m	60 m	100 m	134 m
1.1/4"	43 mm	20 m	35 m	60 m	84 m
1.1/2"	50 mm	15 m	30 m	50 m	75 m
2"	63 mm	10 m	20 m	30 m	43 m

230V electric hose reel power supply

The On/Off push button must be installed **between the electric motor and 230V power supply**. An internal reduction unit allows the hose to be correctly wound on the drum.

SINGLE-PHASE 230V DC MOTOR, 370W POWER AND CONDENSER TO INCREASE INITIAL INRUSH

⚠ Attention: check the electrical connection for the correct direction of motor rotation.

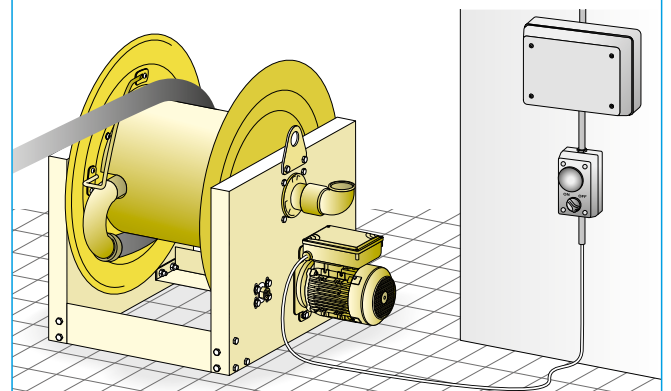

OVERALL DIMENSIONS

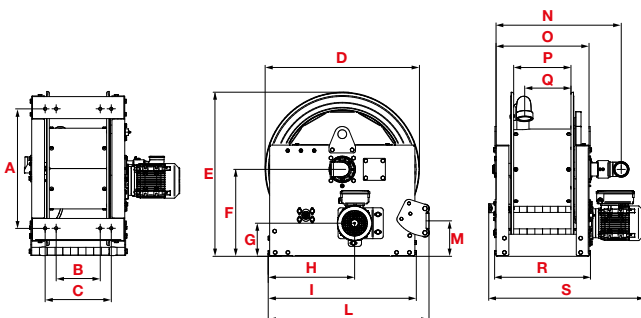

Art.	A	B	C	D	E	F	G	H	I	L	M	N	O	P	Q	R	S	1-m ³	Kg
L 270	542	200	300	700	760	410	150	390	670	730	160	570	422	260	210	435	680	0,53	102
L 410	542	340	440	700	760	410	150	390	670	730	160	712	562	398	350	575	844	0,63	113
L 550	542	480	580	700	760	410	150	390	670	730	160	850	705	538	490	717	965	0,73	120
L 690	542	620	720	700	760	410	150	390	670	730	160	990	842	680	630	855	1100	0,82	136



SERIES 700 HYDRAULIC PAINTED STEEL

The hose reels with hydraulic motor are a handy and easy answer to the problem of hose management. Hose unwinding occurs manually whereas rewinding is done with the hydraulic motor connected to a special control unit as indicated in the figure below.



	width 270 mm	width 410 mm	width 550 mm	width 690 mm	Connection	
					inlet	outlet
20 bar Air - Water Diesel fuel - swivel joint aluminium - seals in Viton®	7721801.100	7741801.100	7751801.100	7771801.100	2"	2"
70 bar Oil and allied products - swivel joint in carbon steel - seals in Viton®	7721801.400	7741801.400	7751801.400	7771801.400	2"	2"

DRUM CAPACITY					
Ø HOSE	Ø HOSE EXT.	L270	L410	L550	L690
3/8"	17 mm	160 m	290 m	420 m	550 m
1/2"	20 mm	110 m	180 m	280 m	350 m
3/4"	27 mm	65 m	120 m	180 m	244 m
1"	34 mm	30 m	60 m	100 m	134 m
1.1/4"	43 mm	20 m	35 m	60 m	84 m
1.1/2"	50 mm	15 m	30 m	50 m	75 m
2"	63 mm	10 m	20 m	30 m	43 m

Hydraulic hose reel feed

The hydraulic motor must be connected to a special control unit equipped with a pump with electric motor, hydraulic oil tank and a control system operated by the user to rewind the hose.

HYDRAULIC MOTOR, OIL PRESSURE MAX. 170 BAR
FOR A FEED OF 5 L/MIN

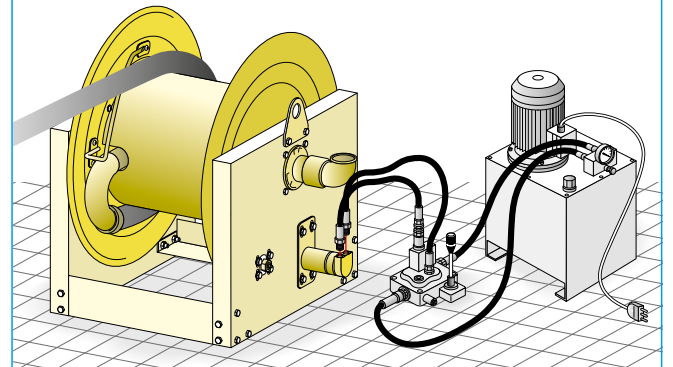

OVERALL DIMENSIONS

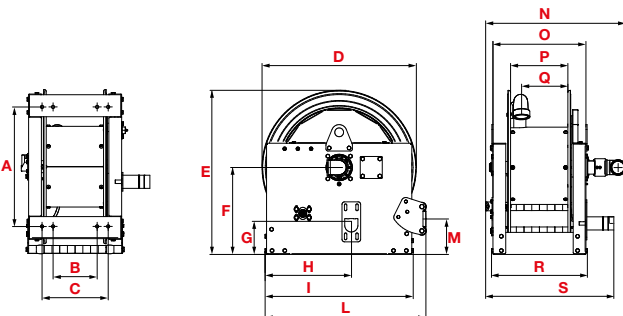

Art.	A	B	C	D	E	F	G	H	I	L	M	N	O	P	Q	R	S	1-m ³	Kg
L 270	542	200	300	700	760	410	150	390	670	730	160	640	422	260	210	435	555	0,53	91
L 410	542	340	440	700	760	410	150	390	670	730	160	782	562	398	350	575	695	0,63	102
L 550	542	480	580	700	760	410	150	390	670	730	160	920	705	538	490	717	840	0,73	109
L 690	542	620	720	700	760	410	150	390	670	730	160	1060	842	680	630	855	975	0,82	125



SERIES 700 PNEUMATIC PAINTED STEEL

The hose reels with pneumatic motor are a handy and easy answer to the problem of hose management. Hose unwinding occurs manually whereas rewinding is done with the pneumatic motor connected to the compressed air supply as indicated in the figure below.



Mounting the clutch P/N 77/2F hose reels is in accordance with the ATEX Certification



	width 270 mm	width 410 mm	width 550 mm	width 690 mm	Connection	
					inlet	outlet
20 bar Air - Water Diesel fuel - swivel joint aluminium - seals in Viton®	7721901.100	7741901.100	7751901.100	7771901.100	2"	2"
70 bar Oil and allied products - swivel joint in carbon steel - seals in Viton®	7721901.400	7741901.400	7751901.400	7771901.400	2"	2"

DRUM CAPACITY					
Ø HOSE	Ø HOSE EXT.	L270	L410	L550	L690
3/8"	17 mm	160 m	290 m	420 m	550 m
1/2"	20 mm	110 m	180 m	280 m	350 m
3/4"	27 mm	65 m	120 m	180 m	244 m
1"	34 mm	30 m	60 m	100 m	134 m
1.1/4"	43 mm	20 m	35 m	60 m	84 m
1.1/2"	50 mm	15 m	30 m	50 m	75 m
2"	63 mm	10 m	20 m	30 m	43 m

OVERALL DIMENSIONS

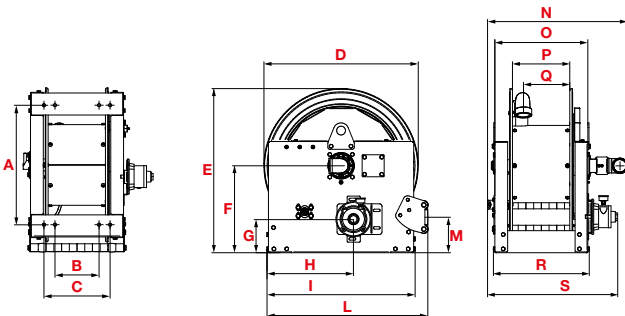

Pneumatic hose reel feed

The hose reel with pneumatic motor must be connected to the compressed air supply, interposing an open/close cock and a pressure regulator for controlling the rewinding force and speed.

PNEUMATIC MOTOR, WORKING PRESSURE
MAX. 7 BAR FOR A CONSUMPTION OF 2000 L/MIN

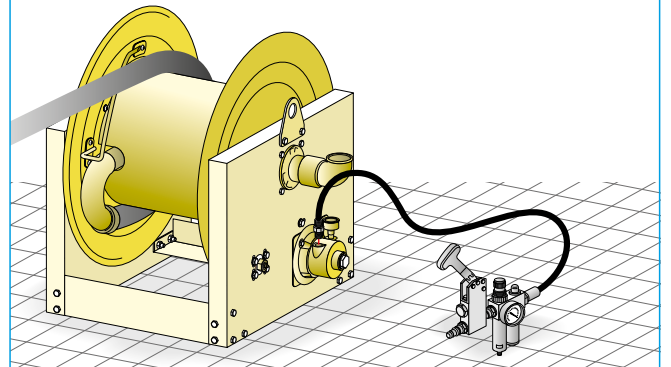

Art.	A	B	C	D	E	F	G	H	I	L	M	N	O	P	Q	R	S	1-m ³	Kg
L 270	542	200	300	700	760	410	150	390	670	730	160	640	422	260	210	435	565	0,53	98
L 410	542	340	440	700	760	410	150	390	670	730	160	782	562	398	350	575	700	0,63	109
L 550	542	480	580	700	760	410	150	390	670	730	160	920	705	538	490	717	845	0,73	116
L 690	542	620	720	700	760	410	150	390	670	730	160	1060	842	680	630	855	985	0,82	131



Accessories hose guide on request



▶ Manual operation hose guide, high

Art. **77/22775B** for width 270 mm
Art. **77/24175B** for width 410 mm
Art. **77/25575B** for width 550 mm
Art. **77/26975B** for width 690 mm

Using the special knob, the operator shifts the hose to the right or left to ensure its correct rewinding.

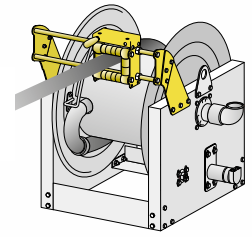

▶ Manual operation hose guide, low

Art. **77/22775** for width 270 mm
Art. **77/24175** for width 410 mm
Art. **77/25575** for width 550 mm
Art. **77/26975** for width 690 mm

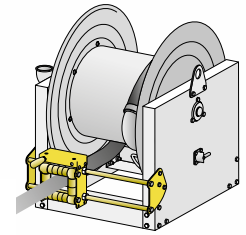

▶ Hose guide standard closed, high

Art. **77/12775B** for width 270 mm
Art. **77/14175B** for width 410 mm
Art. **77/15575B** for width 550 mm
Art. **77/16975B** for width 690 mm

Hose guide with rollers that ensure easy sliding of the hose during unwinding and rewinding.

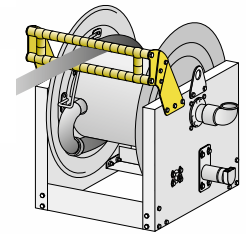

▶ Hose guide standard closed, low

Art. **77/12775** for width 270 mm
Art. **77/14175** for width 410 mm
Art. **77/15575** for width 550 mm
Art. **77/16975** for width 690 mm

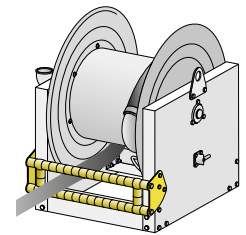

▶ Hose guide standard open, high

Art. **77/32775B** for width 270 mm
Art. **77/34175B** for width 410 mm
Art. **77/35575B** for width 550 mm
Art. **77/36975B** for width 690 mm

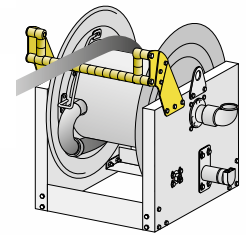

▶ Hose guide standard open, low

Art. **77/32775** for width 270 mm
Art. **77/34175** for width 410 mm
Art. **77/35575** for width 550 mm
Art. **77/36975** for width 690 mm

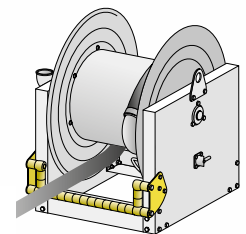

- ▶ Hose guide, standard open high or low.
This type of hose guide enables fitting of both versions (high and low) on the same hose reel, allowing hose unwinding in two opposite directions.

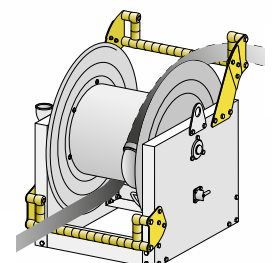



Technical characteristics **clutch** on request

Hose reel with 24V - 230V ELECTRIC - HYDRAULIC - PNEUMATIC motor

The clutch is useful during hose unwinding which is always done manually. It acts on the connection between the crown gears of the hose reel, limiting sliding. Hose unwinding speed is limited by means of the regulating knob, thereby preventing the drum from continuing to turn due to inertia.

Connection between crown gears, on which the clutch acts.

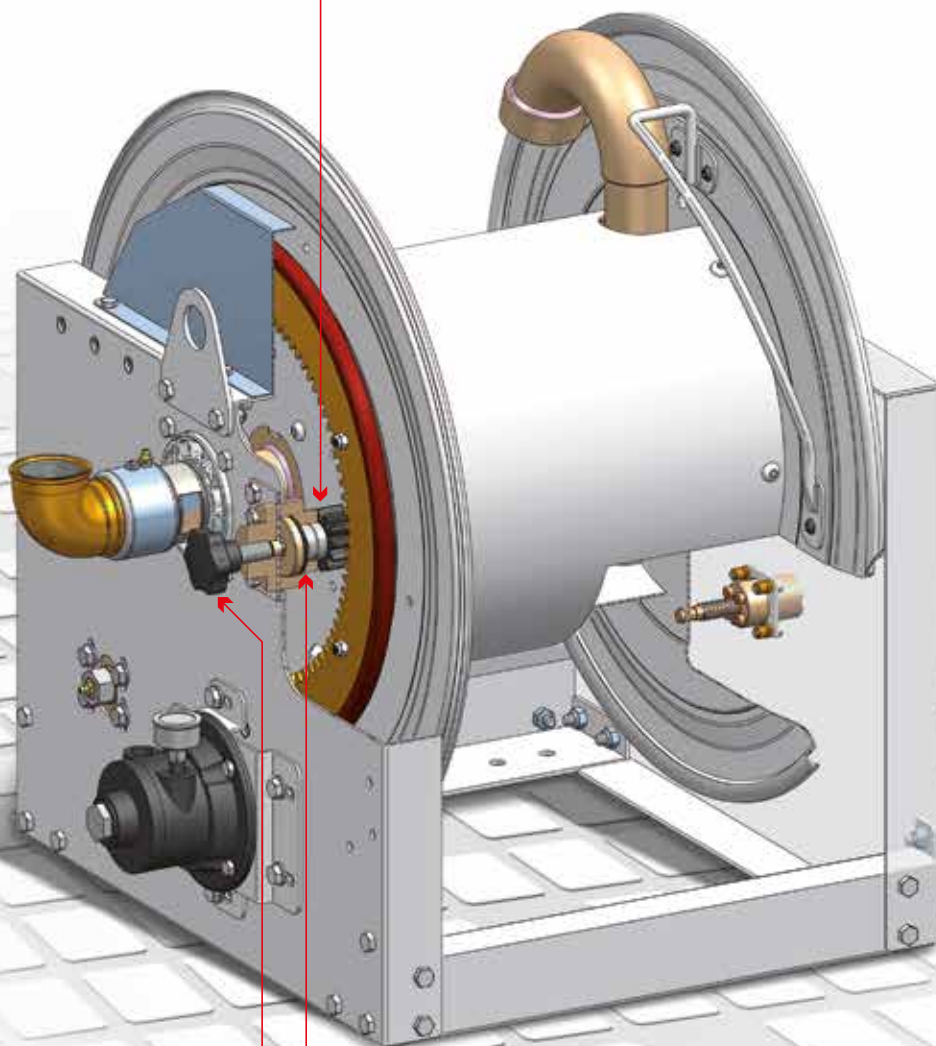

Clutch regulating knob.

Art. 77/2F Clutch

The clutch mounted on a freewheel bearing enables controlled unwinding of the hose, becoming neutral during rewinding.



24V ELECTRIC



230V ELECTRIC



HYDRAULIC



PNEUMATIC

Wall mounting

▶ Drill the necessary holes after choosing the ideal position, checking the solidity and thickness of the wall, marking the holes for the plugs (see template supplied with the hose reel) and ensuring that they will not pierce any plumbing pipes or electrical cables. Fix the plugs in the wall and insert the hose reel in the special seats. Tighten the 4/8 fixing nuts.

1 standard position of lifting hooks. 2 - 3 alternative positions of lifting hooks.

A - B positions of hose guides.

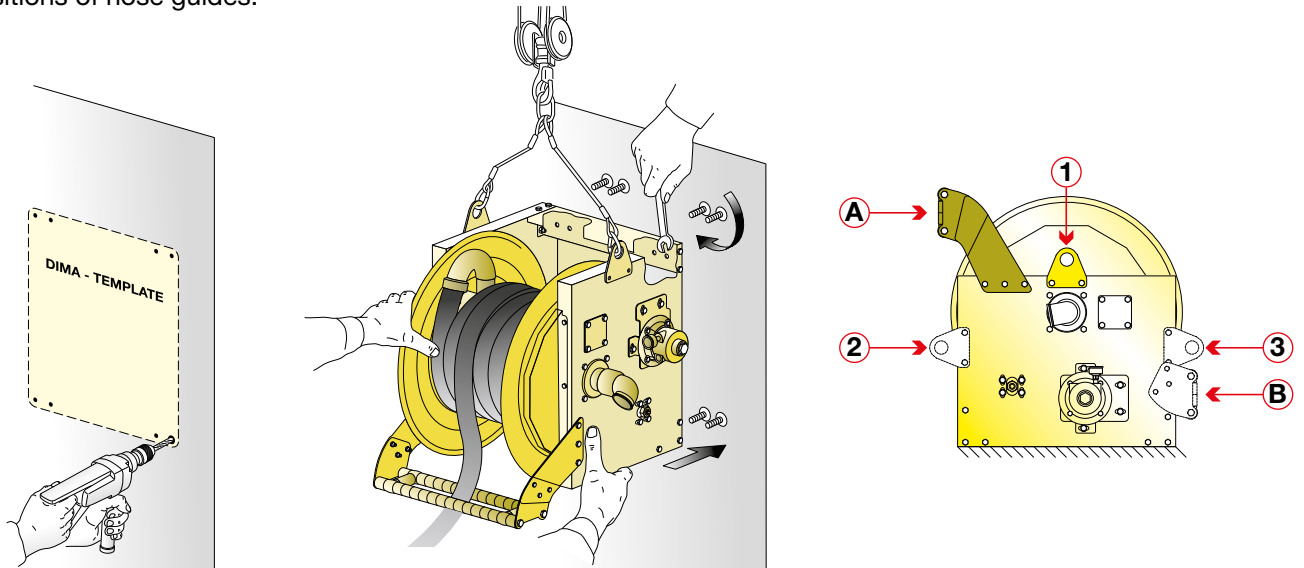

Fitting the hose

▶ Before fitting, make sure the hose reel drum is locked by means of the special brake **F** (see procedures 1 - 2 - 3). Screw a Nipple **N** on the outlet elbow **G**, with sealant. Fit the hose on the Nipple **N**.

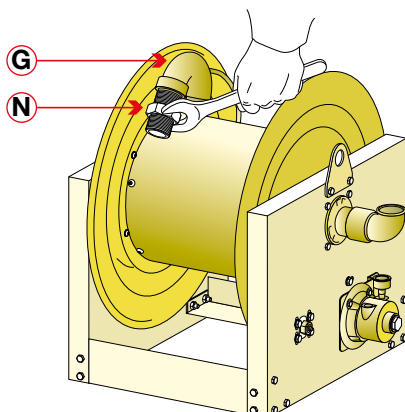
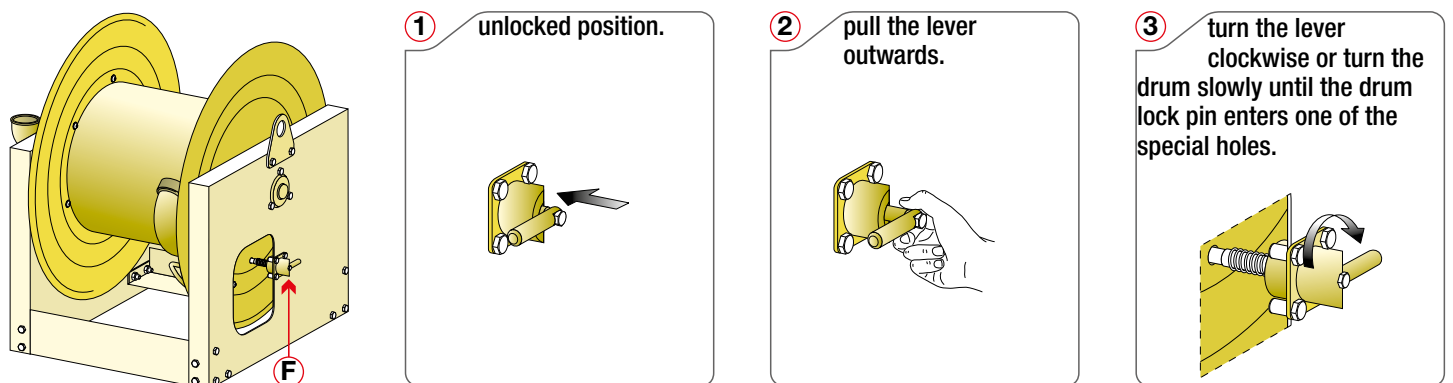

FITTING THE NIPPLE

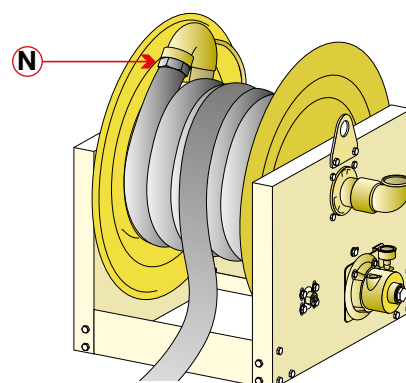

FITTING THE HOSE



RAASM has created a wide range of industrial hose reels to meet the most complex needs in various application sectors such as: industry, agriculture, depots and refineries, mining, aviation, shipyards, fire brigades, automotive, etc.

EXAMPLES of use

industry, agriculture, depots and refineries,
mining, aviation, shipyards, fire brigades,
automotive, etc.

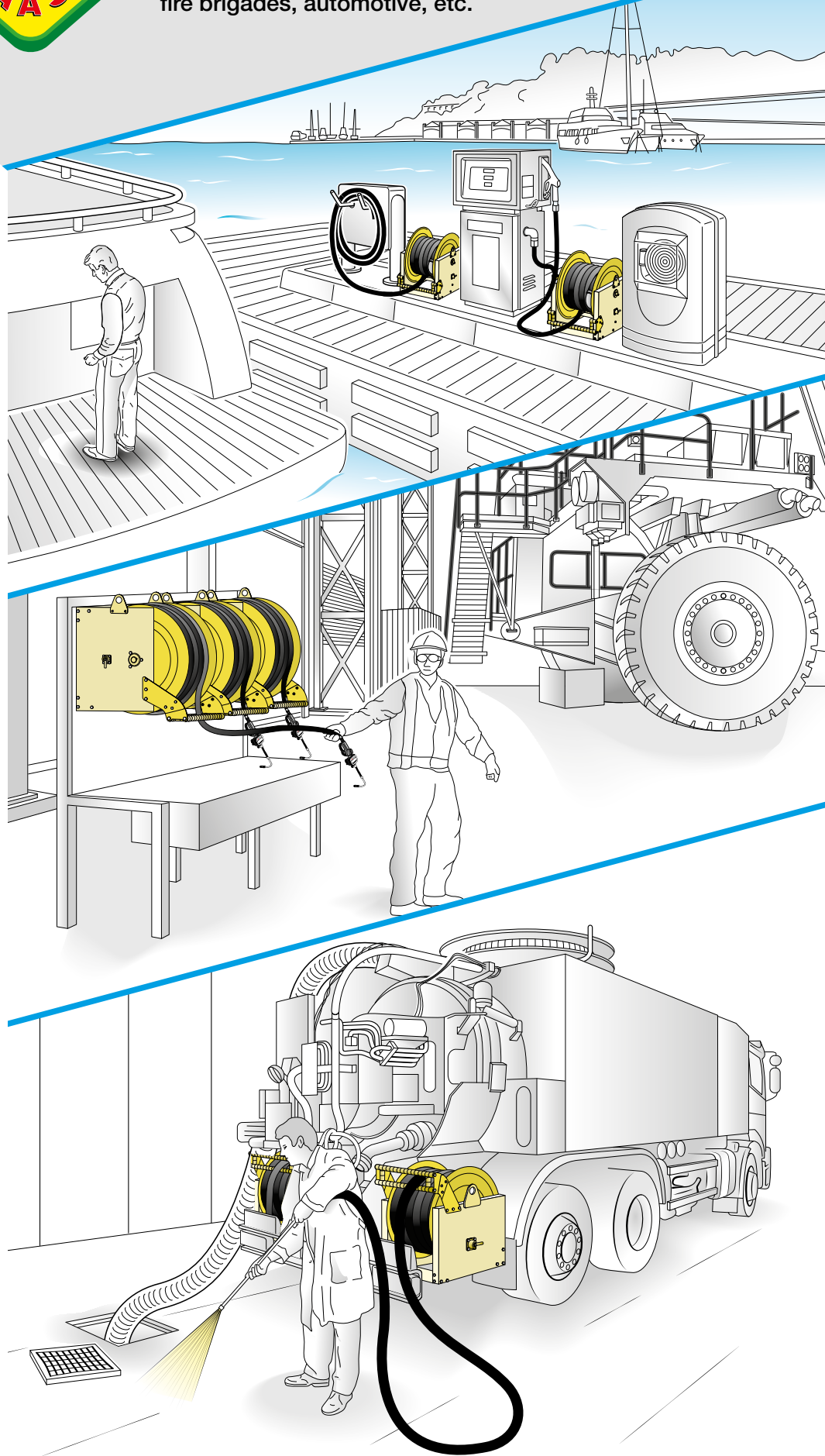



ADVANCED FLUID MANAGEMENT SOLUTIONS

technology, quality, functionality

The starting point for the entire production cycle is the research and development of cutting-edge new solutions which lead to the development of **high quality products, fully produced in Italy.**

The quality of our product manufacturing has always been our absolute priority. To reach this goal rigorous testing accompanies every phase of the manufacturing process.

RAASM offers the most complete range of lubrication products suited to many sectors. Our aim is to always be available to provide solutions to our customers.



Authorized distributor



RAASM S.p.A.
36022 S. ZENO DI CASSOLA (VI)
Via Marangoni, 33 - ITALY

GB

WRCA220/700-GB