



# AIR / WATER - 20 bar

Series 260



SWIVELLING wall support with BAYONET hooking

Article	Hose supplied	Connection	
		inlet	outlet
89010	11m - 8x12 (971.111)	M1/4"G	M1/4"G
89011	11m - 6x10 (971.011)	M1/4"G	M1/4"G

OVERALL DIMENSIONS

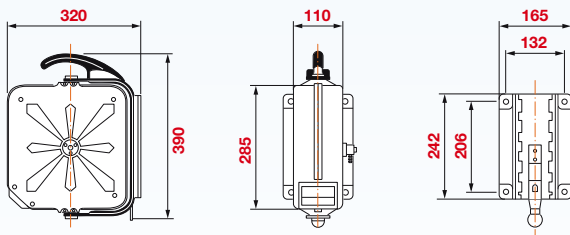

Series 260



SWIVELLING SIMPLE wall support

Article	Hose supplied	Connection	
		inlet	outlet
89109	11m - 8x12 (971.111)	M1/4"G	M1/4"G
89110	11m - 6x10 (971.011)	M1/4"G	M1/4"G

OVERALL DIMENSIONS

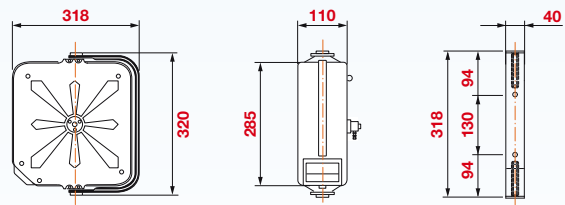

To prevent removal or theft of the hose reel, it can be secured with a bolt or padlock.

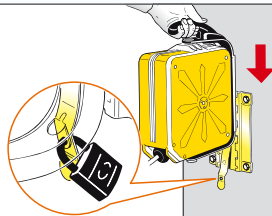

- Supplied with
- polyurethane hose
  - zinc plated steel couplings
  - brass swivel joint
  - "viton" seals



Art. 89001

Series 260 hose reels are equipped with a **wall bracket with bayonet hooking**. The placing of several brackets in the service points allows the hose reel to be easily moved to the various workstations.

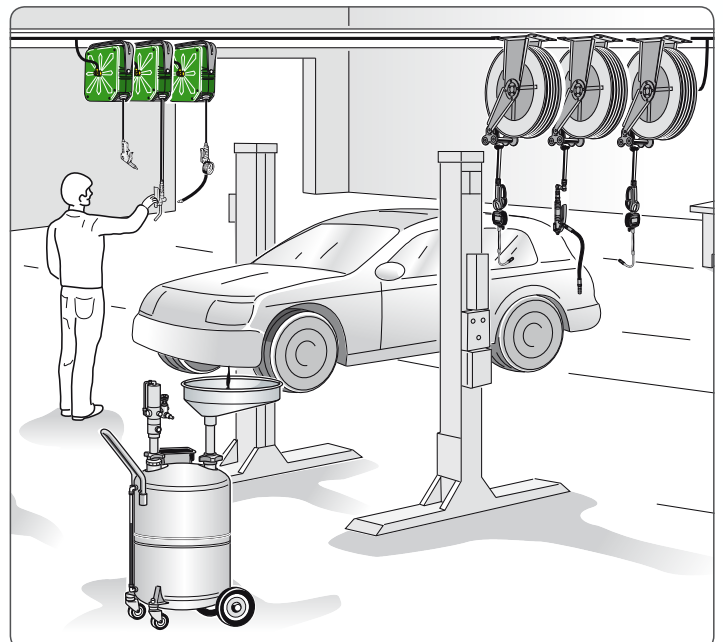
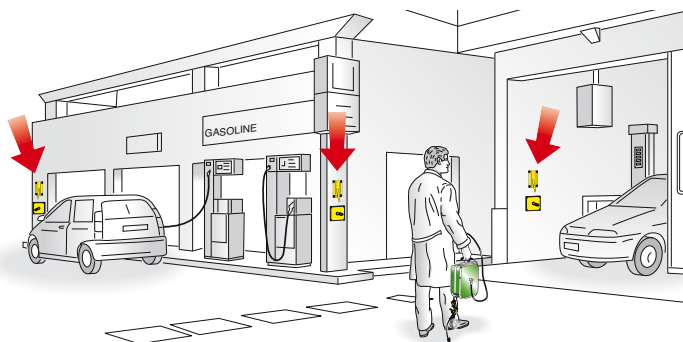



# AIR / WATER - 20 bar PAINTED STEEL



In accordance with directive  
AteX 94/9 II 3 GD c X



## FIXED



- Supplied with:
- polyurethane hose
  - brass fitting
  - brass swivel joint
  - "viton" seals



Article	Hose supplied	Connection	
		inlet	outlet
<b>S. 288</b>	8288.100	without hose	M3/8"G F3/8"G
	8288.102	13m - 10x14,5 (972.113)	M3/8"G M3/8"G
	8288.103	15m - 8x12 (971.115)	M3/8"G M1/4"G
	8288.104	10m - 6x10 (971.010)	M3/8"G M1/4"G
	8288.105	15m - 6x10 (971.015)	M3/8"G M1/4"G
<b>S. 328</b>	8328.100	without hose	M3/8"G F3/8"G
	8328.102	15m - 10x14,5 (972.115)	M3/8"G M3/8"G
	8328.103	18m - 8x12 (971.118)	M3/8"G M1/4"G
	8328.104	8m - 13x19 (976.108)	M1/2"G M1/2"G
	8328.105	12m - 13x19 (976.112)	M1/2"G M1/2"G
<b>S. 378</b>	8378.100	without hose	M3/8"G F3/8"G
	8378.102	20m - 10x14,5 (972.120)	M3/8"G M3/8"G
	8378.103	20m - 8x12 (971.120)	M3/8"G M1/4"G
	8378.104	10m - 13x19 (976.110)	M1/2"G M1/2"G
	8378.105	15m - 13x19 (976.114)	M1/2"G M1/2"G
<b>S. 438</b>	8430.100	without hose	F1/2"G F1/2"G
	8438.101	10m - 13x19 (976.111)	F1/2"G M1/2"G
	8438.102	15m - 13x19 (976.115)	F1/2"G M1/2"G

## FIXED OVERALL DIMENSIONS

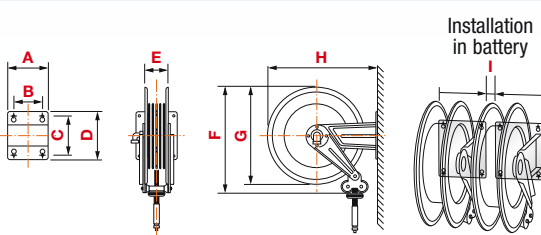

Art.	A	B	C	D	E	F	G	H	I	1-m <sup>3</sup>	Kg *
<b>S. 288</b>	186	140	196	226	110	310	300	320	-	0,037	from 7 to 12
<b>S. 328</b>	186	140	196	226	110	355	350	365	20	0,045	from 8 to 13
<b>S. 378</b>	186	140	196	226	110	400	390	410	20	0,068	from 10 to 17
<b>S. 438</b>	186	140	196	226	115	450	420	460	20	0,098	from 14 to 21

\* The list shows min and max weight for each series: min weight refers to version without hose, max weight refers to heaviest version which depends on hose length and diameter.

## FIXED HOSE REELS INSTALLATION

The quick coupling support is equipped with 4 slot holes that allow an easy and safe installation of the hose reel. The **template** supplied facilitates drilling of the holes and there fore hose reel fixing.

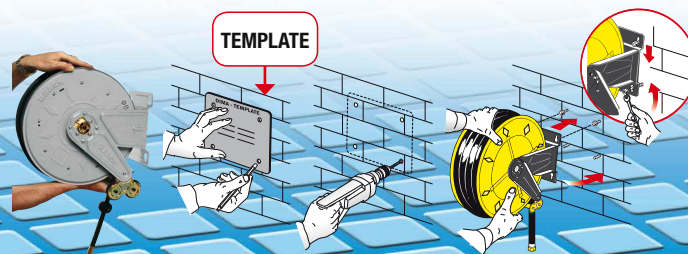





# AIR / WATER - 20 bar PAINTED STEEL



In accordance with directive Atex  
94/9 IIB 2 GD c T4 T135 °C X



**FIXED**

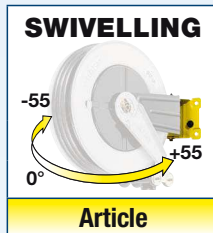

**SWIVELLING**

Supplied with:

- hoses in black synthetic rubber
- zinc plated steel couplings
- brass swivel joint
- "viton" seals



	Article		Hose supplied	Connection	
	inlet	outlet		inlet	outlet
S. 290	8290.100	-	without hose	F3/8"G	F3/8"G
	8290.101	-	10m - 3/8" (995.210)	F3/8"G	M3/8"G
	8290.104	-	15m - 1/4" (993.215)	F3/8"G	M1/4"G
S. 330	8330.100	-	without hose	F3/8"G	F3/8"G
	8330.101	-	12m - 3/8" (995.211)	F3/8"G	M3/8"G
S. 390	8390.100	8380.100	without hose	F3/8"G	F3/8"G
	8390.102	8380.102	18m - 3/8" (995.217)	F3/8"G	M3/8"G
S. 430	8430.100	8420.100	without hose	F1/2"G	F1/2"G
	8430.101	8420.101	12m - 3/8" (995.212)	F1/2"G	M3/8"G
	8430.102	8420.102	18m - 3/8" (995.218)	F1/2"G	M3/8"G
	8430.103	8420.103	10m - 1/2" (996.210)	F1/2"G	M1/2"G
	8430.104	8420.104	15m - 1/2" (996.215)	F1/2"G	M1/2"G
for ABS hose reels Series 430 see page 152					
S. 530	8530.100	8520.100	without hose	F1/2"G	F1/2"G
	8530.101	8520.101	20m - 1/2" (996.220)	F1/2"G	M1/2"G
	8530.102	8520.102	25m - 1/2" (996.225)	F1/2"G	M1/2"G
S. 540	8540.100	8550.100	without hose	F1"G	F1"G
	8540.101	8550.101	15m - 3/4" (997.215)	F1"G	M3/4"G
	8540.102	8550.102	20m - 3/4" (997.220)	F1"G	M3/4"G
	8540.103	8550.103	15m - 1" (998.215)	F1"G	M1"G
	8540.105	8550.105	without hose	F1/2"G	F1/2"G
	8540.106	8550.106	30m - 1/2" (996.230)	F1/2"G	M1/2"G
S. 560	8560.100	-	without hose	F1"G	F1"G
	8560.101	-	30m - 3/4" (997.230)	F1"G	M3/4"G
	8560.103	-	40m - 3/4" (997.240)	F1"G	M3/4"G
	8560.104	-	20m - 1" (998.220)	F1"G	M1"G
	8560.105	-	30m - 1" (998.230)	F1"G	M1"G
	8560.106	-	without hose	F1/2"G	F1/2"G

## FIXED HOSE REELS INSTALLATION

The quick coupling support is equipped with 4 slot holes that allow an easy and safe installation of the hose reel. The **template** supplied facilitates drilling of the holes and therefore hose reel fixing.

## SWIVELLING HOSE REELS INSTALLATION

The **quick coupling swivelling support** facilitates hose reel installation and enables **55° rotation** to the right or left or locking in **fixed positioned at 0°** by means of clamping with two screws.

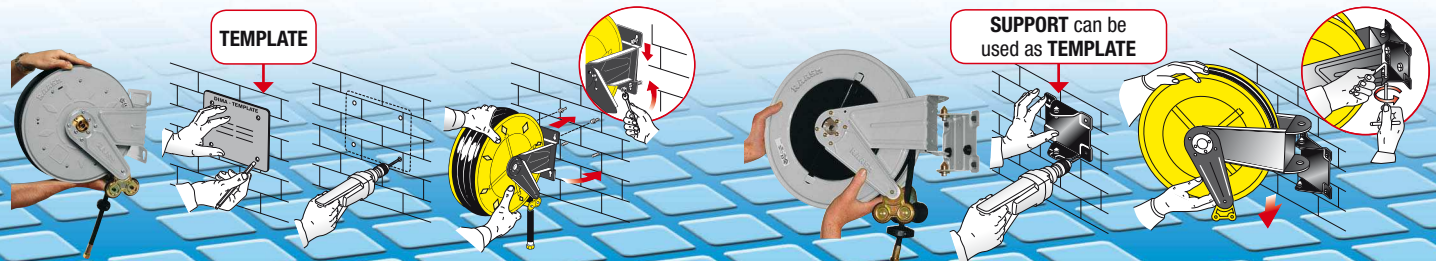



# AIR / WATER - 20 bar STAINLESS STEEL



In accordance with directive Atex  
94/9 IIB 2 GD c T4 T135 °C X

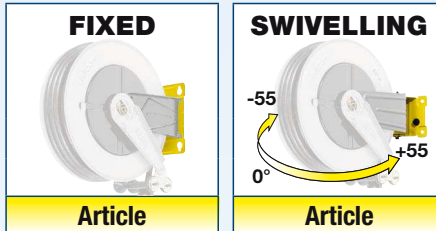

- Supplied with:
- hoses in black synthetic rubber
  - zinc plated steel couplings
  - brass swivel joint
  - "viton" seals



Article	Article	Hose supplied	Connection	
			inlet	outlet
<b>S. 290</b>	8292.100	-		
	8292.101	-		
	8292.104	-		
<b>S. 330</b>	8332.100	-		
	8332.101	-		
<b>S. 390</b>	8392.100	8382.100	without hose	F3/8"G F3/8"G
	8392.102	8382.102	18m - 3/8" (995.217)	F3/8"G M3/8"G
<b>S. 430</b>	8432.100	8422.100	without hose	F1/2"G F1/2"G
	8432.101	8422.101	12m - 3/8" (995.212)	F1/2"G M3/8"G
	8432.102	8422.102	18m - 3/8" (995.218)	F1/2"G M3/8"G
	8432.103	8422.103	10m - 1/2" (996.210)	F1/2"G M1/2"G
	8432.104	8422.104	15m - 1/2" (996.215)	F1/2"G M1/2"G
for ABS hose reels Series 430 see page 153				
<b>S. 530</b>	8532.100	8522.100	without hose	F1/2"G F1/2"G
	8532.101	8522.101	20m - 1/2" (996.220)	F1/2"G M1/2"G
	8532.102	8522.102	25m - 1/2" (996.225)	F1/2"G M1/2"G
<b>S. 540</b>	8542.100	8552.100	without hose	F1"G F1"G
	8542.101	8552.101	15m - 3/4" (997.215)	F1"G M3/4"G
	8542.102	8552.102	20m - 3/4" (997.220)	F1"G M3/4"G
	8542.103	8552.103	15m - 1" (998.215)	F1"G M1"G
	8542.105	8552.105	without hose	F1/2"G F1/2"G
<b>S. 560</b>	8562.100	8552.106	30m - 1/2" (996.230)	F1/2"G M1/2"G
	8562.101	-	without hose	F1"G F1"G
	8562.103	-	30m - 3/4" (997.230)	F1"G M3/4"G
	8562.104	-	40m - 3/4" (997.240)	F1"G M3/4"G
	8562.105	-	20m - 1" (998.220)	F1"G M1"G
8562.106	-	30m - 1" (998.230)	F1"G M1"G	
			without hose	F1/2"G F1/2"G

## FIXED OVERALL DIMENSIONS

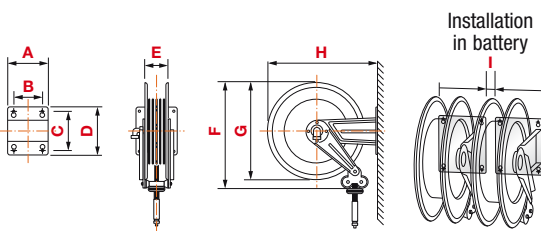

Art.	A	B	C	D	E	F	G	H	I	1-m <sup>3</sup>	Kg*
<b>S. 290</b>	186	140	196	226	110	310	300	320	-	0,037	from 7 to 12
<b>S. 330</b>	186	140	196	226	110	355	350	365	20	0,045	from 8 to 13
<b>S. 390</b>	186	140	196	226	110	400	390	410	20	0,068	from 11 to 18
<b>S. 430</b>	186	140	196	226	115	460	420	460	20	0,098	from 14 to 24
<b>S. 530</b>	203	153	220	258	115	550	510	560	20	0,120	from 19 to 42
<b>S. 540</b>	300	218	228	268	190	550	510	573	0	0,175	from 24 to 40
<b>S. 560</b>	488	399	238	272	368	550	510	578	0	0,310	from 30 to 80

## SWIVELLING OVERALL DIMENSIONS

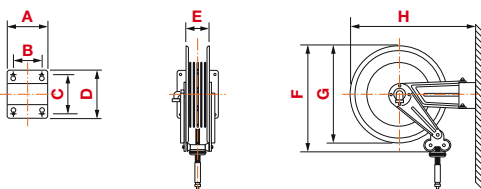

Art.	A	B	C	D	E	F	G	H	1-m <sup>3</sup>	Kg
<b>S. 380</b>	184	146	106	144	110	400	390	484	0,098	from 12 to 19
<b>S. 420</b>	208	162	118	164	115	460	420	541	0,098	from 15 to 25
<b>S. 520</b>	228	182	154	200	115	560	510	642	0,120	from 20 to 43
<b>S. 550</b>	300	218	226	268	190	560	510	702	0,175	from 25 to 41

\* The list shows min and max weight for each series: min weight refers to version without hose, max weight refers to heaviest version which depends on hose length and diameter.